

1 Bed First Floor Flat

£1,150 per month



Caroline Place UB3 5AF

SOUGHT AFTER LOCATION / 1 BEDROOM FLAT: Popular style of 1 bedroom apartment in sought after modern development near Heathrow Airport and the Bath Road and with easy access to the M4/M25 motorway networks. Hayes and Harlington train station and Hatton Cross tube station (Piccadilly Line) are also only a short drive away.

This well laid out first floor apartment is set in well kept communal grounds and features a communal hallway, fitted kitchen with gas hob, electric oven, extractor fan, spacious living room, double bedroom and a fitted shower room.

Other benefits include double glazed windows, gas central heating and residents permit parking.

- * Minimum Tenancy 6 Months
- * Deposit £1,150
- * Council Tax Band C

Accommodation

One Bedroom Apartment

Fully Fitted Kitchen +
Appliances

Allocated Residents
Parking

Double Bedroom +
Wardrobes

Gas Central Heating

Available 29 August 2023

EPC Rating C

Ground Floor

Entrance - Communal entrance with carpeted stairs to upper floors.

First Floor

Lounge - 14' 9" x 10' 5" (4.5m x 3.2m) Carpet flooring and radiator. Double glazed window to rear aspect.

Bedroom - 11' 5" x 8' 7" (3.5m x 2.63m) Carpet flooring, built in wardrobes with sliding doors and a radiator. Double glazed window to front aspect.

Kitchen - 10' 9" x 5' 10" (3.3m x 1.8m) Vinyl flooring, built in cupboard and radiator. Fitted wall and base units with worktops to include a single drainer sink unit, gas hob, extractor fan hood, electric oven, washing machine, fridge and part tiled walls and splashbacks. Double glazed window to rear aspect

Bathroom - Vinyl flooring, extractor fan and radiator. Three-piece shower room suite to include a panel enclosed bath with shower mixer taps, pedestal hand basin, low level W.C. and part tiled walls and splashbacks.

Exterior

Outside - Well kept communal garden and residents permit parking

About Harlington - Harlington is a district of the London Borough of Hillingdon, on the northern perimeter of London Heathrow Airport. The district adjoins Hayes to the north and shares a railway station with the larger district, which is its post town, on the Great Western Main Line to Paddington. The Crossrail project linking the Hayes and Harlington station to Canary Wharf. The journey time to Canary Wharf will be just 34 minutes. Other London stations will include Bond Street, Tottenham Court Road, Farringdon and Liverpool Street.

The village is surrounded by Green Belt land and open fields and also contains a parade of shops to include a Pharmacy, Co-operative Convenience store, Newsagents, a variety of restaurants and fast food outlets and a Post Office. There are also four public houses: The Great Western, The Pheasant, The Wheatsheaf, and The White Hart. The village also boasts two churches, a Baptist church and a Church of England church, St Peter & St Paul's and William Byrd School. The village High Street is also home to the Harlington Locomotive Society and West London Models.



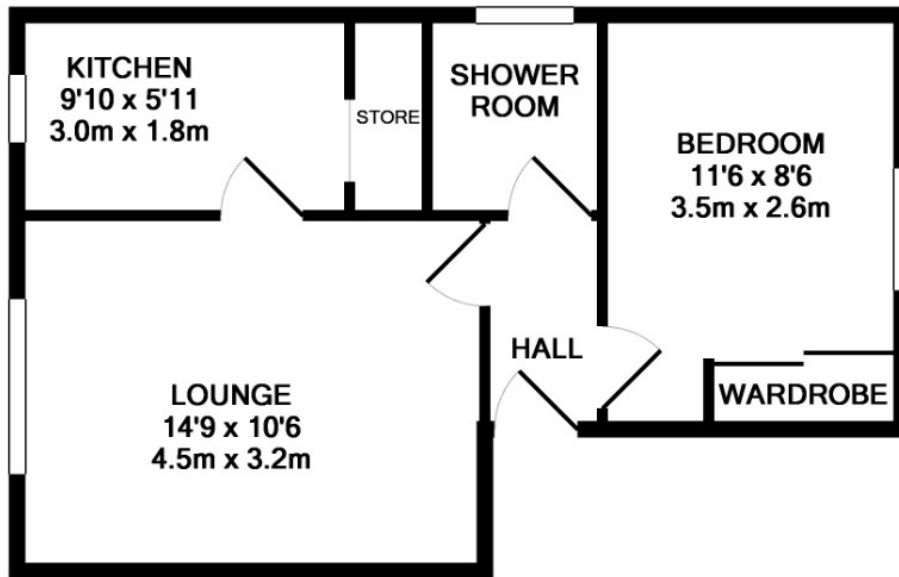

TOTAL APPROX. FLOOR AREA 379 SQ.FT. (35.2 SQ.M.)

Whilst every attempt has been made to ensure the accuracy of the floor plan contained here, measurements of doors, windows, rooms and any other items are approximate and no responsibility is taken for any error, omission, or mis-statement. This plan is for illustrative purposes only and should be used as such by any prospective purchaser. The services, systems and appliances shown have not been tested and no guarantee as to their operability or efficiency can be given
Made with Metropix ©2017

