

1 Bed Flat

**£1,150** per month



## **Pennine Way UB3 5LW**

**AVAILABLE IMMEDIATELY:** This unfurnished 1 bedroom apartment is situated near the Bath Road and is perfectly located for London Heathrow Airport. Hayes mainline station to Paddington is only a bus ride away.

This features an entrance hall, double bedroom, shower-room with walk-in shower with glass screen and open plan living area with kitchen.

Fully equipped this property is perfect for a professional looking to be near Heathrow and internal viewing is highly recommended.

- \* Minimum Tenancy 6 Months
- \* Deposit £1,150
- \* Council Tax Band B

## **Accommodation**

**One Bedroom Ground Floor Apartment**

**Available Immediately**

**Convenient Popular Location**

**Unfurnished**

**Excellent Transport Links**

**Kitchen / Open Plan Lounge**

**Perfect For Bath Road / Heathrow**

**EPC Rating C**

## Ground Floor

**Entrance** - uPVC front door.

**Living Room / Kitchen** - 16' 4" x 8' 2" (5m x 2.5m) Laminate flooring and radiator. Double glazed sliding door.

Fitted wall and base units with worktops to include a single drainer sink unit, gas hob, electric oven, space for fridge and part tiled walls and splashbacks.

**Bedroom 1** - 8' 2" x 11' 5" (2.5m x 3.5m) Laminate flooring and radiator. Double glazed window to front aspect.

**Bathroom** - Three-piece bathroom suite to include a enclosed shower unit, hand basin, low level W.C. and part tiled walls and splashbacks.



## Exterior

**Outside** - Residents Permit Parking.

**About Harlington** - Harlington is a district of the London Borough of Hillingdon, on the northern perimeter of London Heathrow Airport. The district adjoins Hayes to the north and shares a railway station with the larger district, which is its post town, on the Great Western Main Line to Paddington.

The village is surrounded by Green Belt land and open fields and also contains a parade of shops to include a Pharmacy, Co-operative Convenience store, Newsagents, a variety of restaurants and fast food outlets and a Post Office. There are also four public houses: The Great Western, The Pheasant, The Wheatsheaf, and The White Hart. The village also boasts two churches, a Baptist church and a Church of England church, St Peter & St Paul's and William Byrd School.

GROUND FLOOR

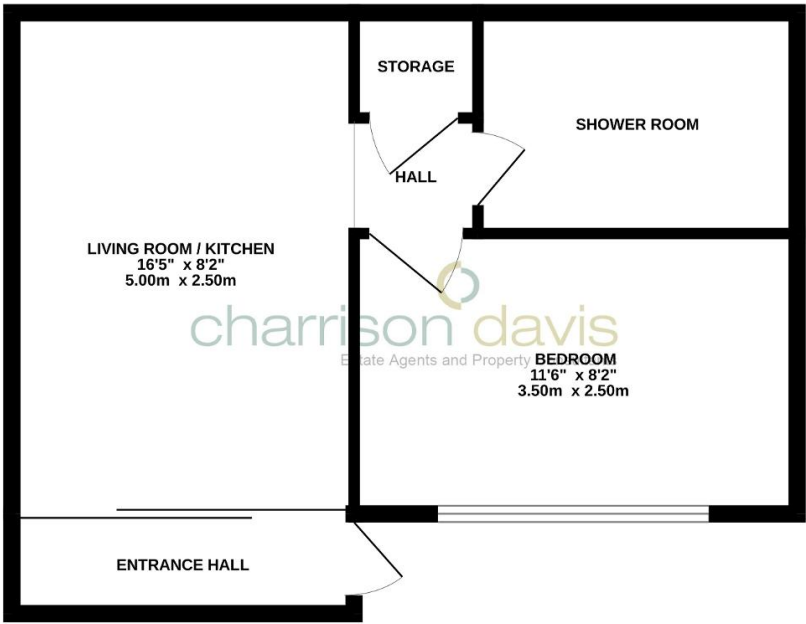

Whilst every attempt has been made to ensure the accuracy of the floorplan contained here, measurements of doors, windows, rooms and any other items are approximate and no responsibility is taken for any error, omission or mis-statement. This plan is for illustrative purposes only and should be used as such by any prospective purchaser. The services, systems and appliances shown have not been tested and no guarantee as to their operability or efficiency can be given.  
Made with Metropix ©2025

Score	Energy rating	Current	Potential
92+	A		93 A
81-91	B		
69-80	C	73 C	
55-68	D		
39-54	E		
21-38	F		
1-20	G		